

SP&D-KSLC90-1193
REV 3

KSLC - 90 PNEUMATIC SENSOR LEVEL CONTROL

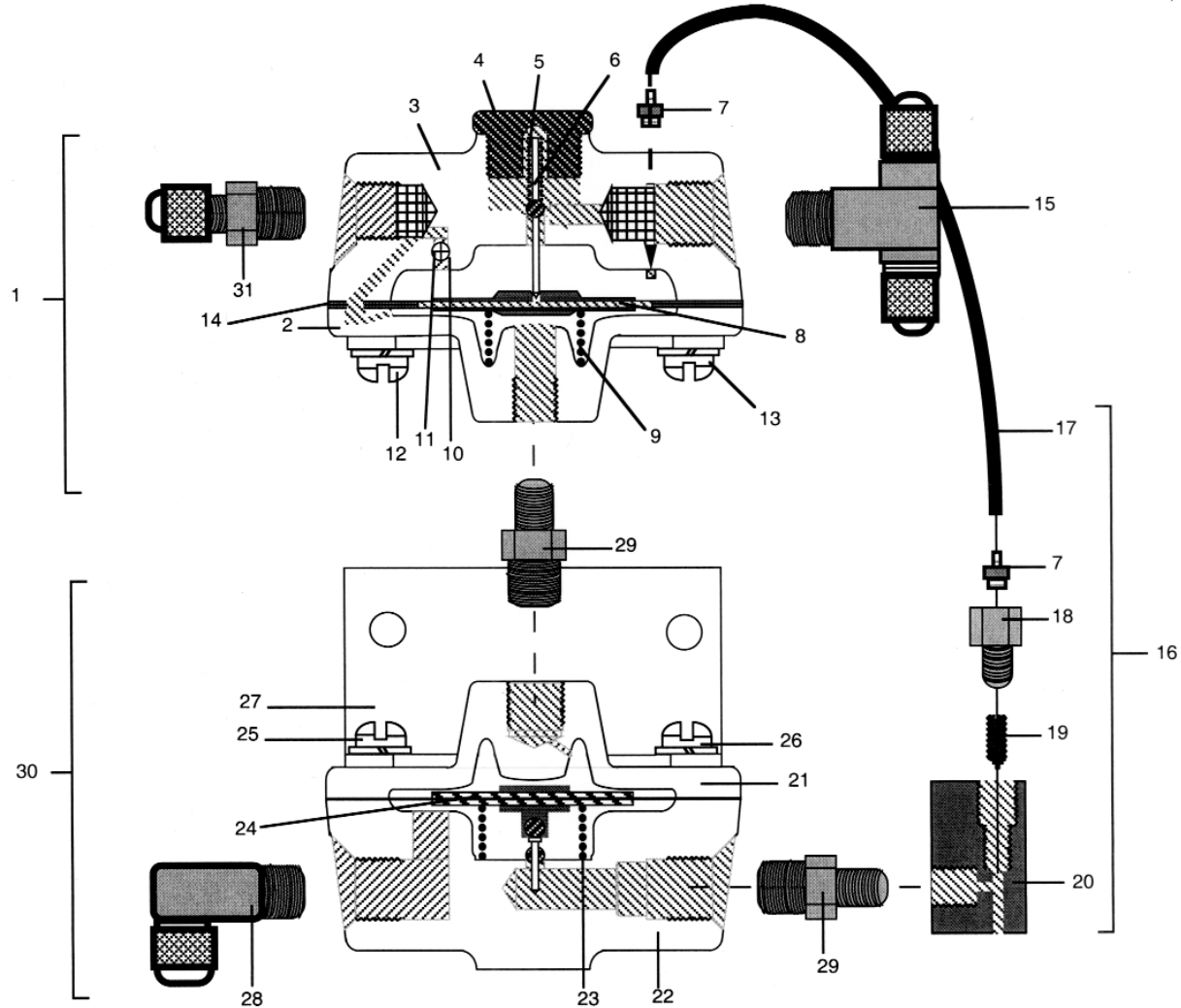

ITEM	PART NUMBER	DESCRIPTION	QTY	ITEM	PART NUMBER	DESCRIPTION	QTY
1		CD Relay (includes Items 2-14)	1	16	K8990-A	Vent Conditioner (Includes Items 17-20)	1
2	7135-16	Housing-T	1	17	5233K514	Tubing	
3	7135-2	Housing-B	1	18		Bushing	
4 *	2155-6	Retaining Nut	1	19		Orifice Screw	
5 *	2155-7	Valve Spring	1	20		Block	
6 *	2155-244	Plunger	1	21	2881-9	Housing-TBU	1
7	272-1-1032	Fitting	2	22	2882-18	Housing-BBU	1
8 *	713519-10323	Diaphragm/Disc Assy.	1	23 **	8665-10	Spring	1
9 *	572-31	Differential Spring	1	24 **	2882-8	Valve & Diaphragm Assy.	1
10 *	7135-9/8912-10	Cleaning Wire Screw	1	25	3410BU-34	1/4-20 X 3/4 Screw	3
11 *	71358-29385/8912-2	Orifice Screw w/ O-Ring	1	26	3410BU-58	1/4-20 X 5/8 Screw	3
12	1-3345	1/4-20 x 7/8 Screw	3	27	1145-19	Mounting Brack et	1
13	1-3410	1/4-20 x 1 Screw	3	28	AP69P4X4/KQL07-35S	Elbow	1
14 *	1447-3	Exhaust assy	1	29	1234X2	1/4X1/8 Nipple	2
14A	1447-3DX	Diaphragm Only	1	30		CD Flow Relay	1
15	AP72P4X4/KQT07-35S	Tee	1	31	AP68P4X4/KQH07-35S	Connector	1

* Parts included upper assembly service kit * 62U595-3

** Parts included lower assembly service kit * 63L595-2
** 2155-225 Screen(not shown) QTY. 2